

Kinghelm®

| REVISIONS | | | | | |
|-----------|--------|-------------|-----|-----|------|
| REV | NUMBER | DESCRIPTION | DWN | CHK | DATE |
| A | | DESIGN | | | |
| | | | | | |

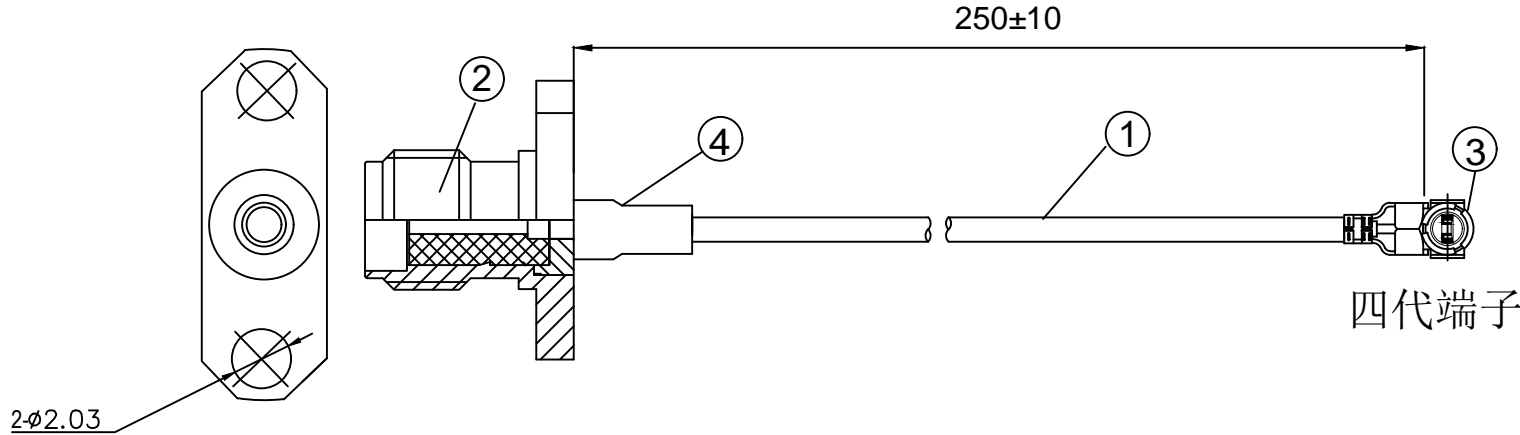

四代端子

NOTES:

1. ELECTRICAL:
 - 1.1. VOLTAGE RATING:DCV 300V 10MS
 - 1.2. CONDUCTANCE RESISTANCE: 3.0 OHM/MAX.
 - 1.3. INSULATION RESISTANCE: 5.0M OHM/MIN.
 - 1.4. THE CABLE SHOULD BE 100% ELECTRICAL TEST
 - 1.5. IT SHOULD BE NO ANY OPEN/SHORT, MISWIRING AND INTERMITTENT FAILURES.
2. MATERIAL:
 - 2.1. SEE TABLE
3. ALL COMPONENTS ARE RoHS COMPLIANT.

| ITEM NO. | PART NUMBER | DESCRIPTION | QTY. |
|----------|-------------|-------------------------------|------|
| ④ | 套管 | 黑色热缩套管, OD:2.0MM | AS |
| ③ | 端子 | 高仿I-PEX ,1.13 四代端子, 镀金 | 1 |
| ② | 接头 | SMA母头母针, 2孔法兰, 镀金, 外螺纹内孔 | 1 |
| ① | 同轴线 | RF1.13cable, 黑色同轴线, OD:1.13mm | AS |

深圳市金航标电子有限公司

www.kinghelm.com.cn

SHENZHEN KINGHELM ELECTRON CO., LTD.

0755-28190160

| | | | |
|----------------------------------|--|--------------------|------------------------------|
| ALL DIMENSION ARE IN MM | DRAWN Jamy | DATE 2023-08-18 | KH-FL2SMAK-IPEX4-RG1.13-B250 |
| | ENG. | | |
| COMPUTER GENERATED IN SOLIDWORKS | MFG. | | |
| DO NOT SCALE THIS DRAWING | Q.A. | | |
| PROJECTION | GENERAL TOLERANCE FOR ANGLES X.X X.XX X.XXX ± 1° ± 0.3 ± 0.25 ± 0.150 | | SIZE Number B |
| CUSTOMER P/N: | | | REV A |
| | SCALE: Free | TYPE | SHEET 1 OF 1 |