

PCB LAYOUT  
S=2:1

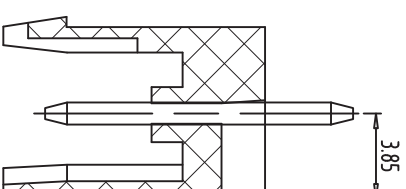

SECTION:A-A

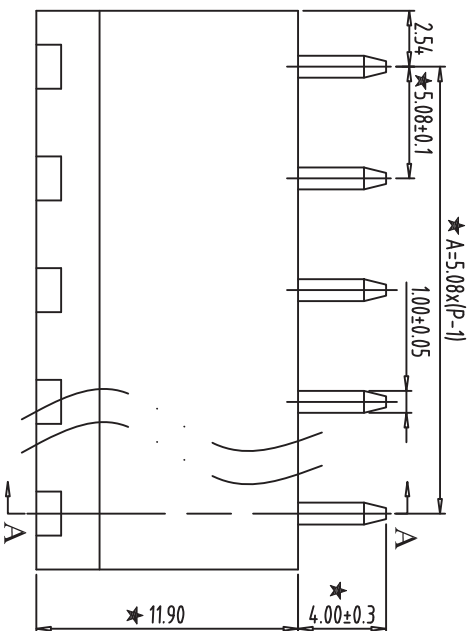
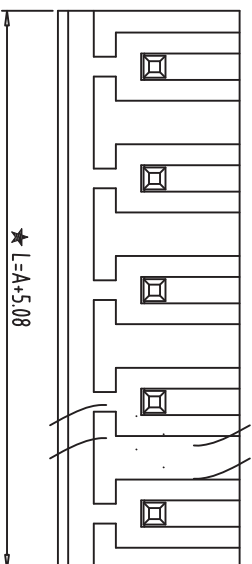
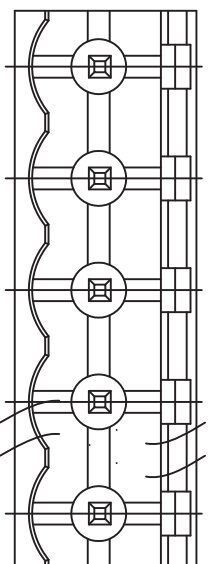
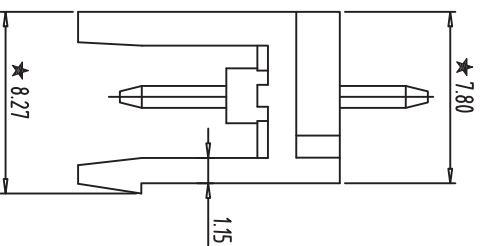

- NOTES:
1. Rating:300V 15A ;
  2. Insulation Withstands Voltage: AC2000V/MIN
  3. Insulation Resistance: 500M $\Omega$  or more at DC500V
  4. Using Temperature Range: -40°C~+105°C
  5. "★" is the important dimension
  6. RoHS compliance

Total Pitch Tolerances		Nominal dimension range																							
In mm		In mm																							
0	over	0	over	30	over	53	over	70	over	90	over	115	over	150	over	250	over	350	over	500	over	700	over	1000	over
±0.18	to	±0.20	to	±0.25	to	±0.3	to	±0.35	to	±0.44	to	±0.50	to	±0.60	to	±0.70	to	±0.85	to	±1.00	to	±1.20	to	±1.50	to

Tolerance		Nominal dimension range	
In mm		In mm	
±	0	0	250
±	0.1	250	500
±	0.2	500	1000
±	0.3	1000	1500
±	0.5	1500	2500

ITEM	NAME OF PART	NO. OF PART	Q'TY	MATERIAL	NOTE
DWG	SK	DATE	2014/08/19	SIZE	A4
CHK		DATE		SCALE	3:1
APP.		DATE		SCALE	2EDG-5.08
深圳市金航标电子有限公司 KH-F400V-6P-5.08G				WWW.BDS666.COM 0755-83044319	